

# WaterMaster 25 Evo

Direct gas fired condensing water heater.



- > Can deliver large peak and continuous volumes of hot water
- > Operates in most efficient mode (fully condensing)
- > Reduces legionella risk due to temperature stored at > 60°C
- > Small footprint allows installation in tight plantrooms
- > Low maintenance with no anode protection required
- > Compliant with latest Ecodesign regulations for DHW
- > Corrosion-resistant stainless steel heat exchanger and tank reduces maintenance and increases system lifespan
- > Suitable for vented or unvented systems (optional Systempak 3 unvented kit required. Kit includes 25l expansion vessel, tundish, pressure control valve, combined pressure reducing set, and vessel mounting bracket.)
- > Easy to use standardised controls using ACVMax control system
- > Compatible for use with LPG and natural gas
- > Supplied with factory fitted T&P relief valve for ease of installation
- > Improved access for service and maintenance
- > 5-year warranty\*

## Tank-in-tank technology

- > **Fast** heat up
- > **Rapid** recovery
- > **Reduced** footprint
- > **Reduced** scale
- > **Low** storage required
- > **Minimal** heat loss



## ACV UK Ltd

St. David's Drive, St. David's Business Park, Dalgety Bay, Fife, KY11 9PF  
uk.sales@acv.com | acv.com

\*Terms & conditions available at [www.acv.com/gb/warranties](http://www.acv.com/gb/warranties).

# Technical data and dimensions



TYPE	UNIT	WM25 Evo
Part number		XB660001
Fuel		Natural gas
Input max (heating) HCV	kW	27.8
Input min (heating)	kW	5
Capacity (total)	L	196
Capacity (domestic hot water)	L	96
Efficiency at 100% load (gross) (EN89)	%	98.2
Efficiency at 100% load (nett) (EN89)	%	108.5
Efficiency at 30% load	%	105.4
Connection - DHW	Ø"	1 M
Connection - gas	Ø"	¾ M
Flue connection	Ømm	80/125
Water pressure drop boiler at $\Delta t = 20^{\circ}\text{C}$	mbar	3
Gas flow rate (max output)	m³/h	2.66
Gas flow rate (min output)	m³/h	0.5
Max operating temperature	°C	87
Max service pressure heating (primary)	bar	3
Max service pressure (DHW)	bar	8.6
Weight (empty)	kg	177
Voltage	V	230
Pre-heating time from 10 to 80°C (Heat source: boiler)	min	35
Standby loss $\Delta T$ 30K	kWh/day	1.9
Standby loss $\Delta T$ 45K	kWh/day	2.98
Standby loss $\Delta T$ 30K	W	79
Standby loss $\Delta T$ 45K	W	124
Declared load profile		L
Water heating efficiency class		A
Water heating energy efficiency (EU 814/2013)	%	87.2
NOx class (EN15502)		6
NOx weighted (GCV) (EN15502)	mg/kWh	21.5
Sound power level indoors LWA (BSEN15036-1)	dB	60

## Domestic hot water performance

TYPE	UNIT	WM25 Evo
Peak flow at 40°C	L/10'	361
Peak flow 1st hour at 40°C	L/60'	1018
Continuous flow at 40°C	L/h	788
Peak flow at 45°C	L/10'	301
Peak flow 1st hour at 45°C	L/60'	865
Continuous flow at 45°C	L/h	676
Peak flow at 60°C	L/10'	183
Peak flow 1st hour at 60°C	L/60'	577
Continuous flow at 60°C	L/h	473

This data assumes an incoming mains water temperature of 10°C.

\*In line with the recommendations specified in UK Building Regulations (2016) Part G, ACV UK Ltd advise the installation of a suitable domestic hot water thermostatic mixing valve on the hot flow immediately after the appliance.

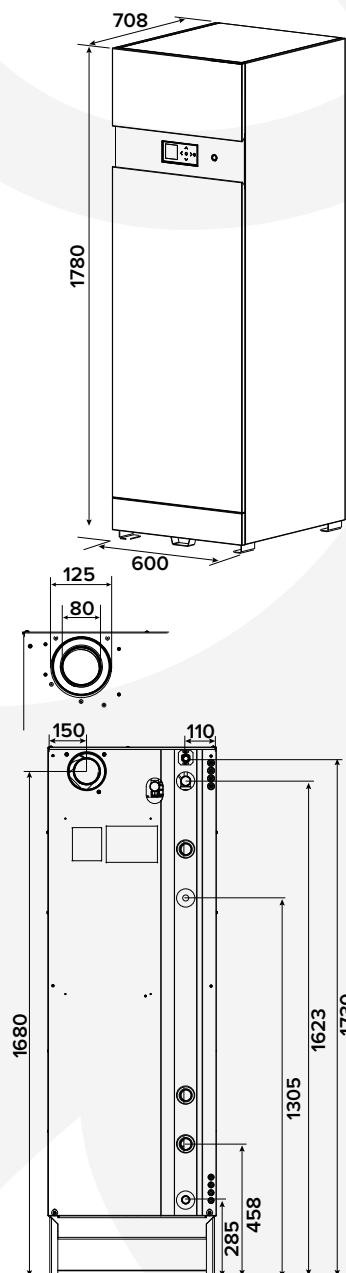

All dimensions in mm.

Clearances	(minimum)
Top	300mm
Left side	600mm
Right side	250mm
Rear	400mm

Every effort has been taken to ensure the details are accurate. ACV UK Limited does not, however, guarantee the accuracy or completeness of any information nor does it accept liability for any errors or omissions in the information. ACV UK Limited reserves the right to make changes and improvements which may necessitate alteration to product specification without prior notice.