

WaterMaster 70 Evo

Direct gas fired condensing water heater.



- > Can deliver large peak and continuous volumes of hot water
- > Operates in most efficient mode (fully condensing)
- > Reduces legionella risk due to temperature stored at > 60°C
- > Small footprint allows installation in tight plantrooms
- > Low maintenance with no anode protection required
- > Compliant with latest Ecodesign regulations for DHW
- > Corrosion-resistant stainless steel heat exchanger and tank reduces maintenance and increases system lifespan
- > Suitable for vented or unvented systems (optional Systempak 3 unvented kit required. Kit includes 25l expansion vessel, tundish, pressure control valve, combined pressure reducing set, and vessel mounting bracket.)
- > Easy to use standardised controls using ACVMax control system
- > Compatible for use with LPG and natural gas
- > Supplied with factory fitted T&P relief valve for ease of installation
- > Improved access for service and maintenance
- > 5-year warranty*

Tank-in-tank technology

- > **Fast** heat up
- > **Rapid** recovery
- > **Reduced** footprint
- > **Reduced** scale
- > **Low** storage required
- > **Minimal** heat loss



ACV UK Ltd

St. David's Drive, St. David's Business Park, Dalgety Bay, Fife, KY11 9PF
uk.sales@acv.com | acv.com

*Terms & conditions available at www.acv.com/gb/warranties.

Technical data and dimensions



TYPE	UNIT	WM70 Evo
Part number		XB660004
Fuel		Natural
Input max (heating) HCV	kW	77.6
Input min (heating)	kW	24.5
Capacity (total)	L	315
Capacity (domestic hot water)	L	190
Efficiency at 100% load (gross) (EN89)	%	98.1
Efficiency at 100% load (nett) (EN89)	%	107.7
Efficiency at 30% load	%	103.9
Connection - DHW	Ø"	1 M
Connection - gas	Ø"	¾ M
Flue connection	Ømm	100/150
Water pressure drop boiler at $\Delta t = 20^{\circ}\text{C}$	mbar	9
Gas flow rate (max output)	m ³ /h	7.4
Gas flow rate (min output)	m ³ /h	2.6
Max operating temperature	°C	87
Max service pressure heating (primary)	bar	3
Max service pressure (DHW)	bar	8.6
Weight (empty)	kg	298
Voltage	V	230
Pre-heating time from 10 to 80°C (Heat source: boiler)	min	27
Standby loss ΔT 30K	kWh/day	2.64
Standby loss ΔT 45K	kWh/day	3.94
Standby loss ΔT 30K	W	110
Standby loss ΔT 45K	W	164
Declared load profile		XXL
Water heating efficiency class		A
Water heating energy efficiency (EU 814/2013)	%	85
NOx class (EN15502)		6
NOx weighted (GCV) (EN15502)	mg/kWh	30.3
Sound power level indoors LWA (BSEN15036-1)	dB	60

Domestic hot water performance

TYPE	UNIT	WM70 Evo
Peak flow at 40°C	L/10'	716
Peak flow 1st hour at 40°C	L/60'	2455
Continuous flow at 40°C	L/h	2087
Peak flow at 45°C	L/10'	592
Peak flow 1st hour at 45°C	L/60'	2083
Continuous flow at 45°C	L/h	1789
Peak flow at 60°C	L/10'	348
Peak flow 1st hour at 60°C	L/60'	1391
Continuous flow at 60°C	L/h	1252

This data assumes an incoming mains water temperature of 10°C.

*In line with the recommendations specified in UK Building Regulations (2016) Part G, ACV UK Ltd advise the installation of a suitable domestic hot water thermostatic mixing valve on the hot flow immediately after the appliance.

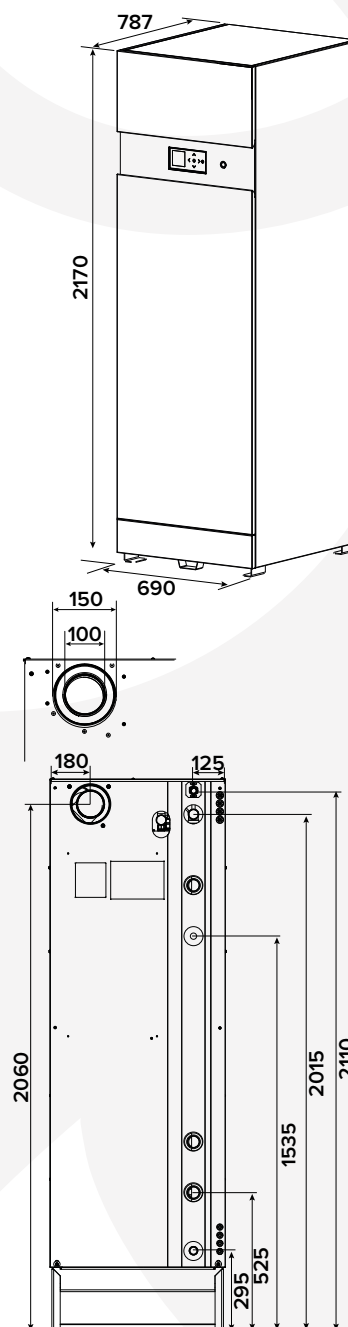

All dimensions in mm.

Clearances	(minimum)
Top	300mm
Left side	600mm
Right side	250mm
Rear	400mm

Every effort has been taken to ensure the details are accurate. ACV UK Limited does not, however, guarantee the accuracy or completeness of any information nor does it accept liability for any errors or omissions in the information. ACV UK Limited reserves the right to make changes and improvements which may necessitate alteration to product specification without prior notice.